

Components & Hardware:

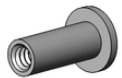

A) Screw post [x2]

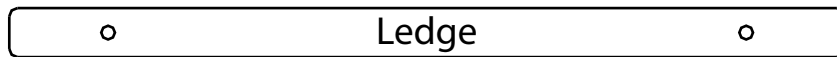
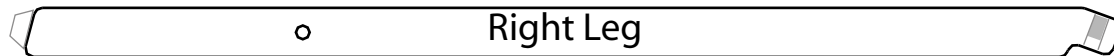

B) Small Washer [x2]



C) 5/8" Screw [x2]



D) 3/32" Wrench



E) Large Washer [x3]

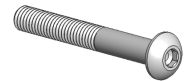

F) 1-3/4" Screw [x1]



G) 5/32" Wrench

Instructions:

1. Attach the Ledge piece to the Left and Right Leg pieces using the Screw Posts (**A**), Small Washers (**B**), and the 5/8" Screws (**C**). See Fig. 1 for visual instructions. Tighten with the 3/32" Wrench (**D**).
2. Attach the Left, Center, and Right Legs using the 1-3/4" Screw (**F**) and Large Washers (**E**). See Fig. 2 for visual instructions. Tighten screw with 5/32" Wrench (**G**).
3. Enjoy your table top easel!

