

## INSTALLATION STEPS 10.09

**Modern appearance, high quality, practical, flexible for multiple uses.  
Carry cases and spotlights are available as accessories. Fast and easy to alter graphics.**

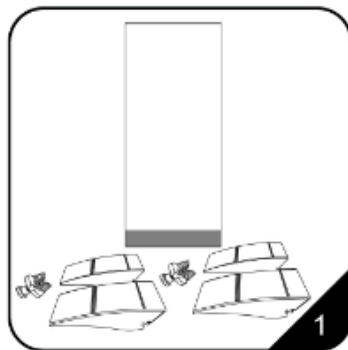

1 : Open the package,all the parts as shown.

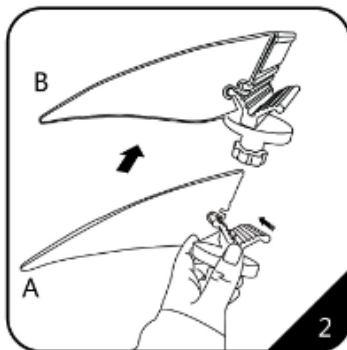

2:Insert the bottom screw as picture A,make to be shape as picture B.

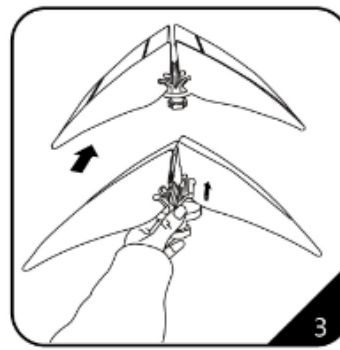

3:Insert the other side of bottom screw to accessory part,to finish the complete foot.

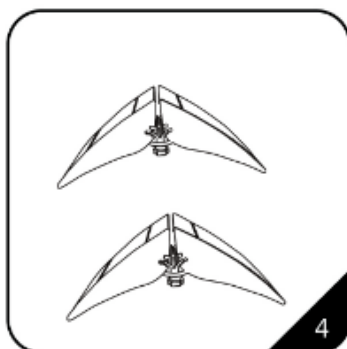

4:Install the accessory parts as picture 2 and picture 3 shown.

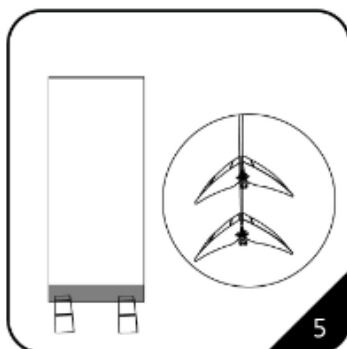

5:Insert the poster board into the gap of the feet,adjust the position.

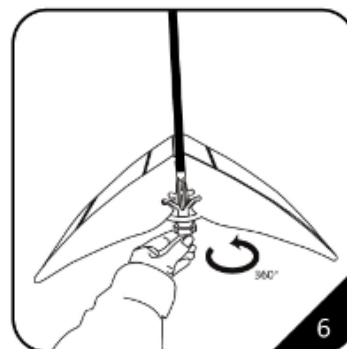

6:Fix the screw on the bottom part.



**CAUTION:  
PLEASE READ THE INSTRUCTIONS BEFORE INSTALLING PRODUCTS**