

# Fisso Ghost

Invisible Sign Standoffs  
FG4618K

# Mounting Instructions

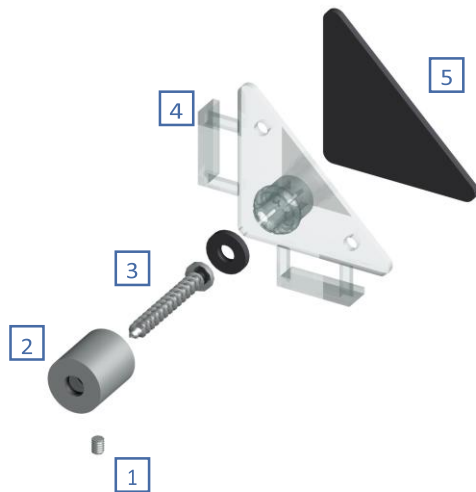

- 1 locking screw
- 2 brass barrel
- 3 mounting screw
- 4 snapping sign fastener
- 5 adhesive pad

NOTE: Every sign panel application must be tested prior to mounting to ensure that the product is appropriate for the material to be used and its weight. Adhesive tape only holds non-coated, non-printed surfaces free from grease and dirt.

1.



Clean your panel and fasteners with alcohol wipes (included).

2.

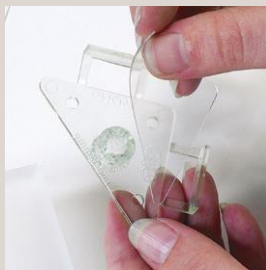

Apply adhesive pad to the fasteners.  
For heavier panels, use screws, glue, or silicone to adhere fastener to panel.

3.



Place fasteners on corners of panel, clicking them into place. Snap off side brackets of fasteners. Let adhesive bind to panel for at least 8 hours.

4.

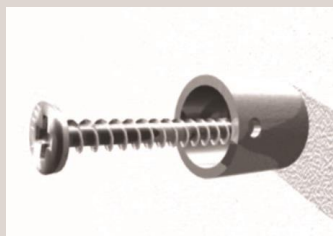

Mark the bore holes using the studs on the fasteners. Drill the mounting holes and install wall anchors. Screw barrels into anchors using mounting screws.

5.



Snap fasteners into barrels.

6.



Tighten and lock with locking screw and hex key.