

# CTSLWPN18 Assembly

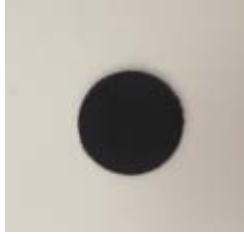

#34 SCREW CAP (x2)



WOOD SCREW (x3)



BOLT (x2)



#58 CAM LOCK (x2)

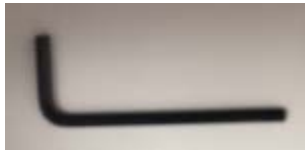

Allen Key (x1)



(A) CENTER PANEL (x1)



(B) TOP PANEL (x1)



(C) BOTTOM(x1)



1. Insert 2 pcs bolt into Top Panel B.

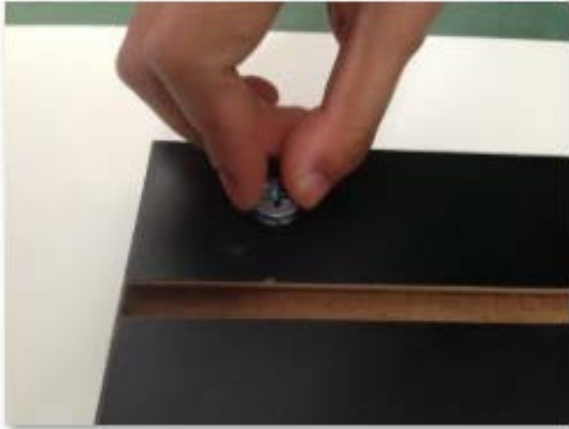

2. Insert cam locks into Center Panel A



3. Align bolts with cam locks to secure Top Panel B onto Center Panel B. Tighten cam locks with screw driver to secure panels together.



4. Flip unit over and secure Bottom C to Center Panel A using provided wood screws and allen key.



5. Snap screw caps into place to cover cam locks.