

ASSEMBLY INSTRUCTIONS

SEG LIGHTBOX - FABRIC BACKLIT DISPLAY

IMPORTANT SAFETY INFORMATION:

This product has been designed for easy assembly and constructed for durability. Please take time to read and follow all instructions before start installing the unit. Be sure you fully understand all the steps needed to finish the installation.

1. Position collapsed pop-up frame with thumb screw feet on the ground. Hold connectors and pull upward until it's in fully upright position. Secure the expanded frame by locking all 6 insert buckles. Locations are shown as circled below.

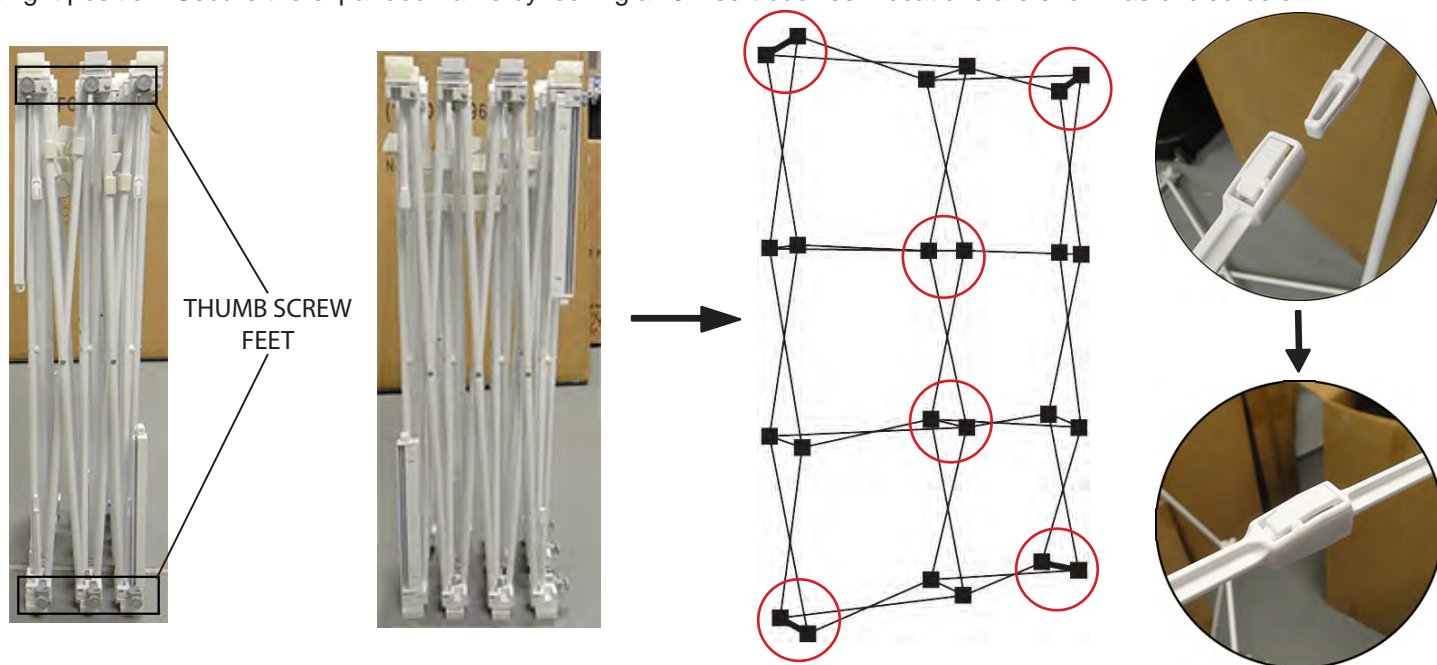

2. Assemble (20) channel bars to all edges of the frame. Find the "T" shaped plastic connector on both ends of the channel bar, and insert one end into the "T" slot in one connecting hub, then insert the other end. In the picture below. "A" indicates the corner connecting hub, "B" indicates the middle connecting hub.

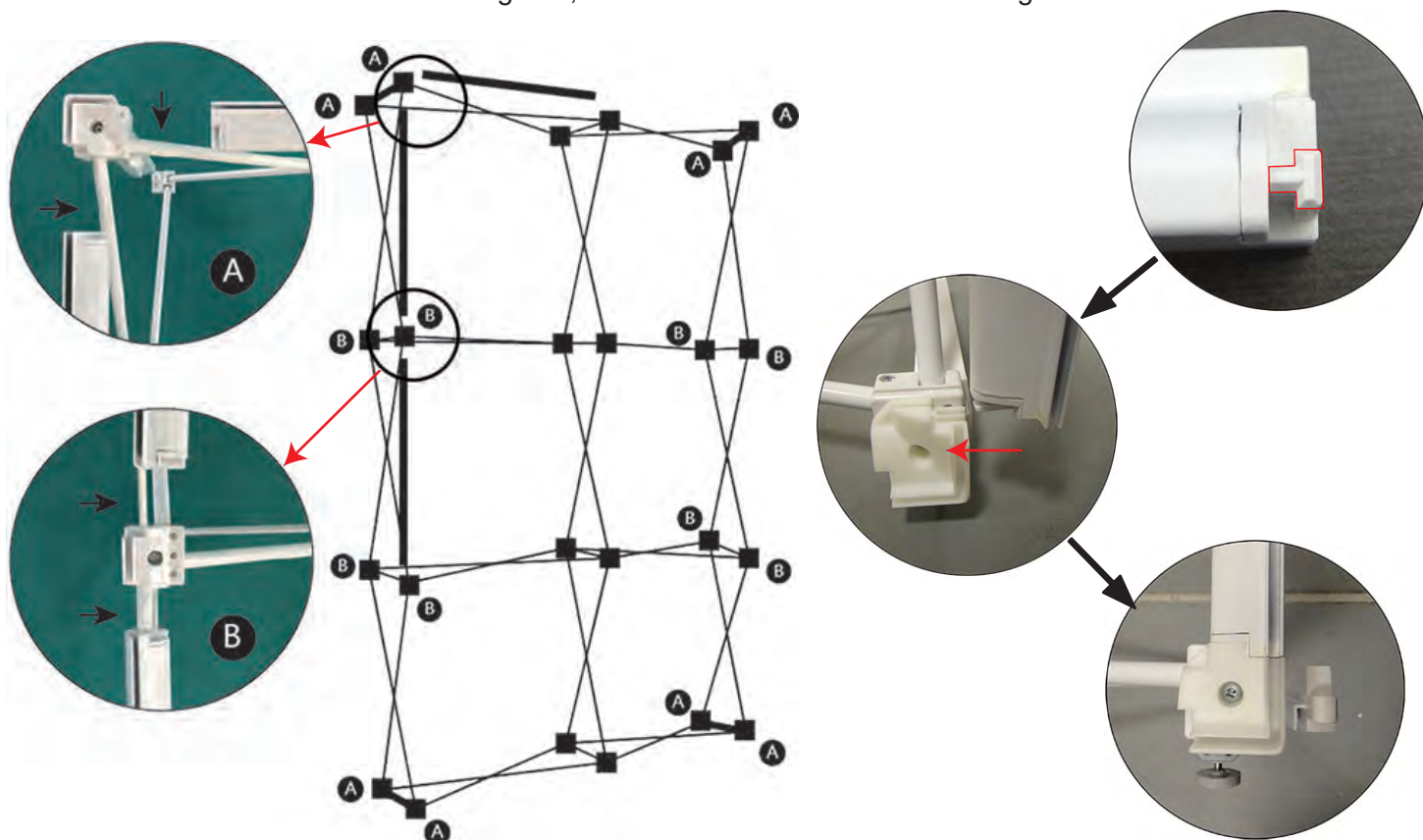

ASSEMBLY INSTRUCTIONS

SEG LIGHTBOX - FABRIC BACKLIT DISPLAY

3. Place the LED light on a clean surface, and carefully roll out the LED ladder panel. Find the "UP" and "DOWN" stickers on light bars, which go into the top and bottom of the frame respectively.

The green arrow sticker indicates which LED bar and the location on the LED bar is locked in white plastic clip.

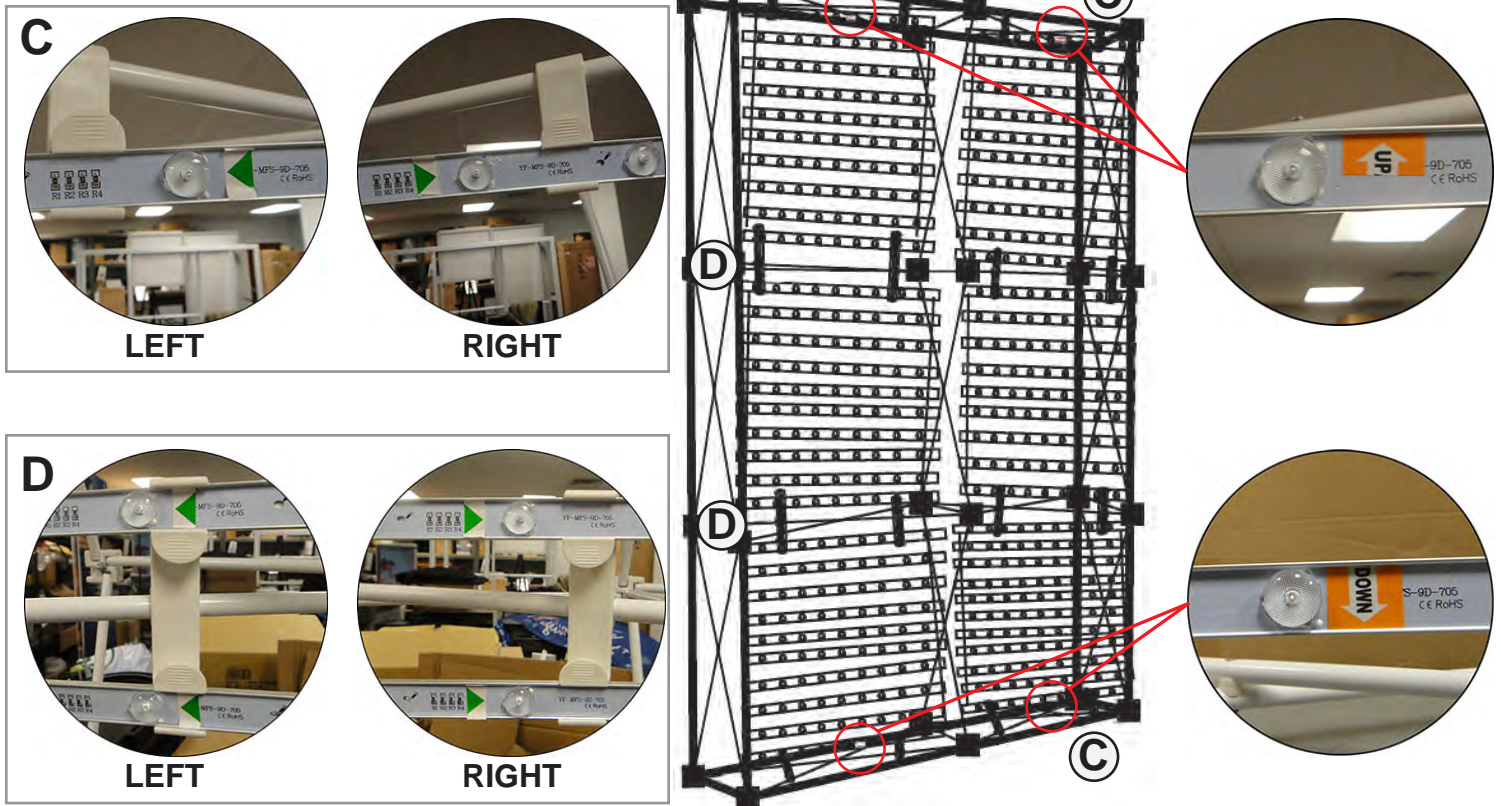

Tips:

- (1). Lay the whole frame on the ground if the top of the expanded frame is hard to reach.
- (2). Push the semicircle shaped tab on plastic bracket to open the clip wider when insert the LED light bar, so the light bar can be clipped on easily.
- (3). When disassembling the LED ladder, push the plastic tab to remove the LED light bar.

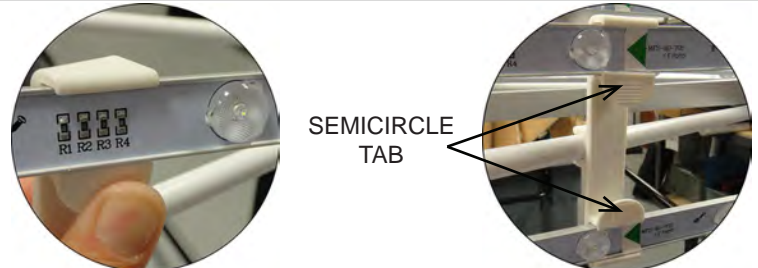

4. Connect the power adapter with the power cord at the bottom of the LED panel.

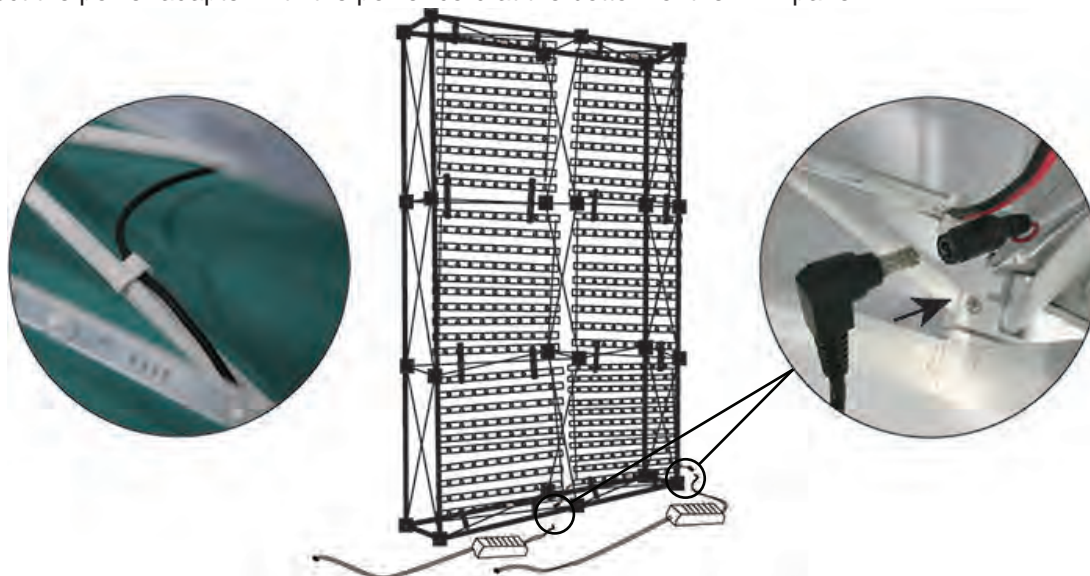

ASSEMBLY INSTRUCTIONS

SEG LIGHTBOX - FABRIC BACKLIT DISPLAY

5. Install flat panel feet on the bottom of the frame. Insert the back thumb screw at one corner into the slot in the foot panel through the pre-cut hole. Slide the foot to the front so the thumb screw goes in, and the other thumb screw falls into the round hole. Repeat this step to install another foot. Adjust both feet to make the frame stable.

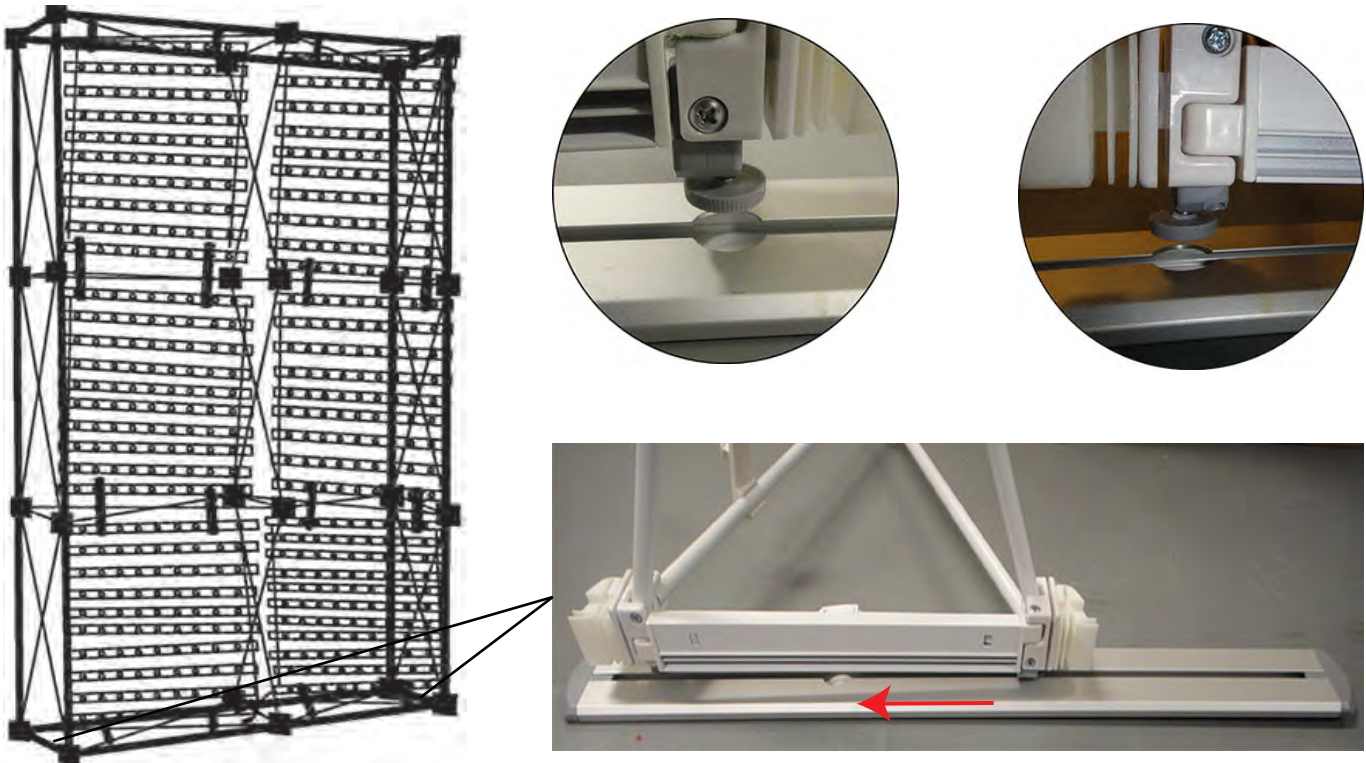

6. Assemble the SEG fabric onto the front and back of the frame by inserting silicon edge into the slot. Be sure the fabric is fully stretched. Plug the power cord to light up the LED panel. The SEG lightbox is ready to use.

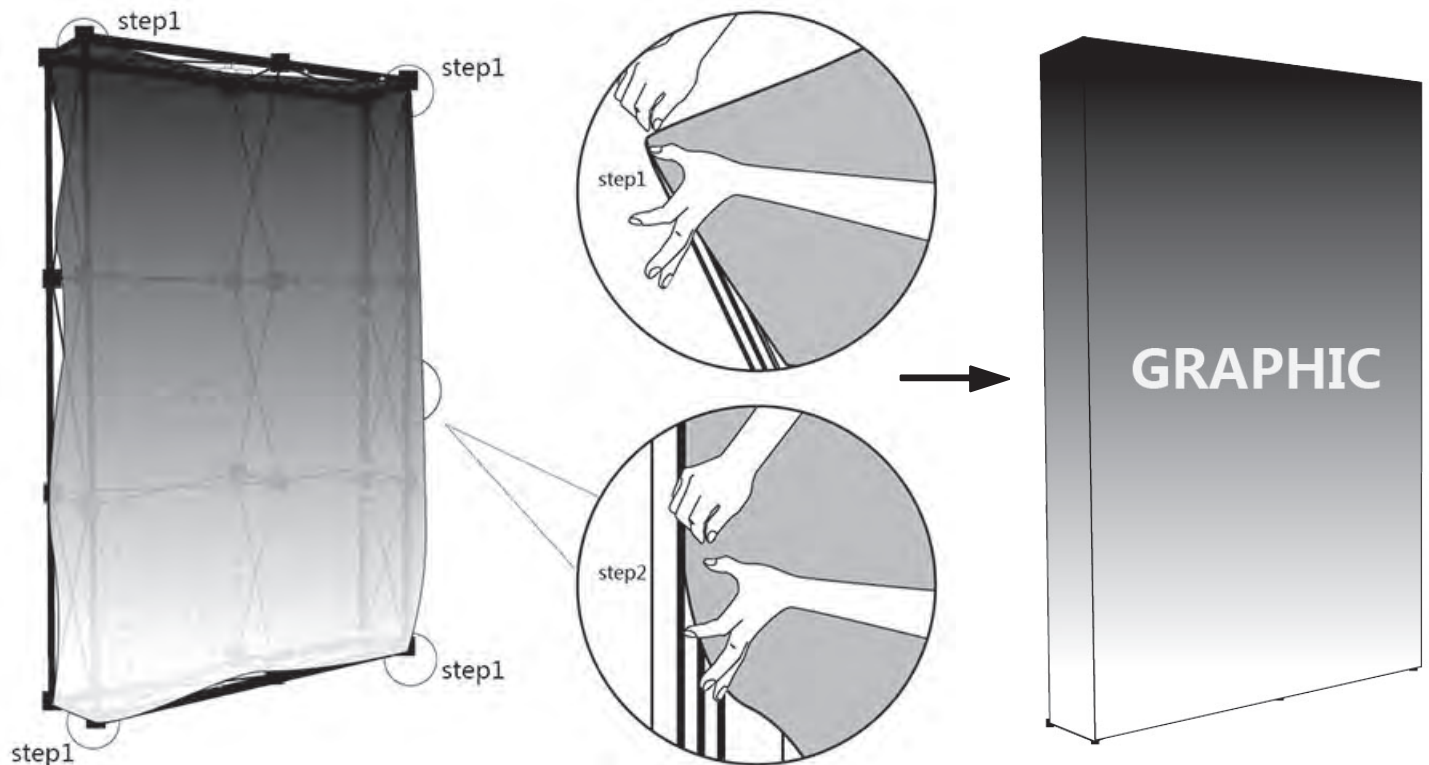

Disclaimer: For additional support or to see assembly in action, visit www.displays2go.com for a how-to video!